

Bạc cầu Series K - Ứng dụng tải nặng

Series GXS

Bạc cầu, tự bôi trơn

Sử dụng cho những ứng dụng có số vòng quay lớn

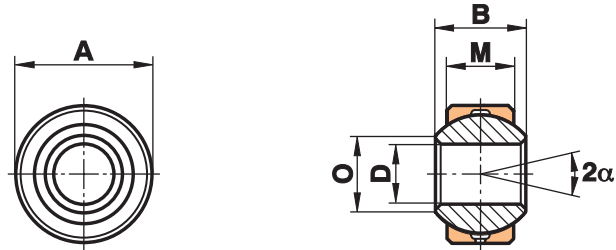

Kích cỡ (D H7)	B	M	A (h6)	O	dK	Tải trọng tĩnh C ₀ kN	Tải trọng động C _k kN	Tốc độ rev/phút	Góc xoay tối đa (°)	Trọng lượng (g)
2 ¹⁾	4,5	3,60	6,5	2,6	5,20	6,6	1,1		16	3
3 ¹⁾	6,0	4,50	9,0	5,1	7,94	10,8	1,8		14	4
4 ¹⁾	7,0	5,25	12,0	6,5	9,52	14,5	2,5		14	4
5 ¹⁾	8,0	6,00	13,0	7,7	11,11	19,8	3,3		13	5
6	9,0	6,75	15,0	8,9	12,70	25,8	4,3	1500	13	8
6.16	9,0	6,75	16,0	8,9	12,70	25,8	4,3	1500	13	9
8	12,0	9,00	18,0	10,4	15,87	42,6	7,1	1200	14	14
8.19	12,0	9,00	19,0	10,4	15,87	42,6	7,1	1200	14	16
10	14,0	10,50	21,0	12,9	19,05	60,0	10,0	1000	13	22
10.22	14,0	10,50	22,0	12,9	19,05	60,0	10,0	1000	13	25
12	16,0	12,00	24,5	15,4	22,22	80,0	13,5	860	13	35
12.26	16,0	12,00	26,0	15,4	22,22	80,0	13,5	860	13	40
14	19,0	13,50	28,0	16,8	25,40	102,5	17,0	750	16	51
14.29	19,0	13,50	29,0	16,8	25,40	102,5	17,0	750	16	56
16	21,0	15,00	31,5	19,3	28,57	128,5	21,5	660	15	72
16.32	21,0	15,00	32,0	19,3	28,57	128,5	21,5	660	15	76
18	23,0	16,50	34,5	21,8	31,75	157,0	26,0	600	15	94
18.35	23,0	16,50	35,0	21,8	31,75	157,0	26,0	600	15	97
20	25,0	18,00	38,0	24,3	34,92	188,5	31,5	540	14	124
20.40	25,0	18,00	40,0	24,3	34,92	188,5	31,5	540	14	141
22	28,0	20,00	41,0	25,8	38,10	229,0	38,0	500	15	158
22.42	28,0	20,00	42,0	25,8	38,10	229,0	38,0	500	15	168
25	31,0	22,00	46,0	29,6	42,86	293,0	47,0	440	15	218
25.47	31,0	22,00	47,0	29,6	42,86	293,0	47,0	440	15	231
30	37,0	25,00	54,0	34,8	50,80	381,0	64,0	370	17	349
30.55	37,0	25,00	55,0	34,8	50,80	381,0	64,0	370	17	362
35	43,0	28,00	62,0	37,7	57,15	480,0	80,0	330	19	502
35.65	43,0	28,00	65,0	37,7	57,15	480,0	80,0	330	19	518
40	49,0	35,00	72,0	44,2	65,96	693,0	116,0	290	16	832
40.75	49,0	35,00	75,0	44,2	65,96	693,0	116,0	290	16	850
50	60,0	45,00	90,0	55,9	82,00	1100,0	185,0	230	14	1600

only for short-term revolutions recommended

Chất liệu:

Lõi: Đồng có độ bền cao CuSn8

Vòng bi: Thép chịu nhiệt 100Cr6, Aisi 52100, cứng, sơn nền, đánh bóng
Seri này có sẵn loại bu lông có ren (xem trang 53).

¹⁾ không có lỗ bôi trơn